

W:\E00045\1A - Dublin Bulk Supply Point\8.0 Drawings\DR\CP1273-RPS-03-PL-SL-D-C-2108 Proposed Typical Roadway Details.dwg

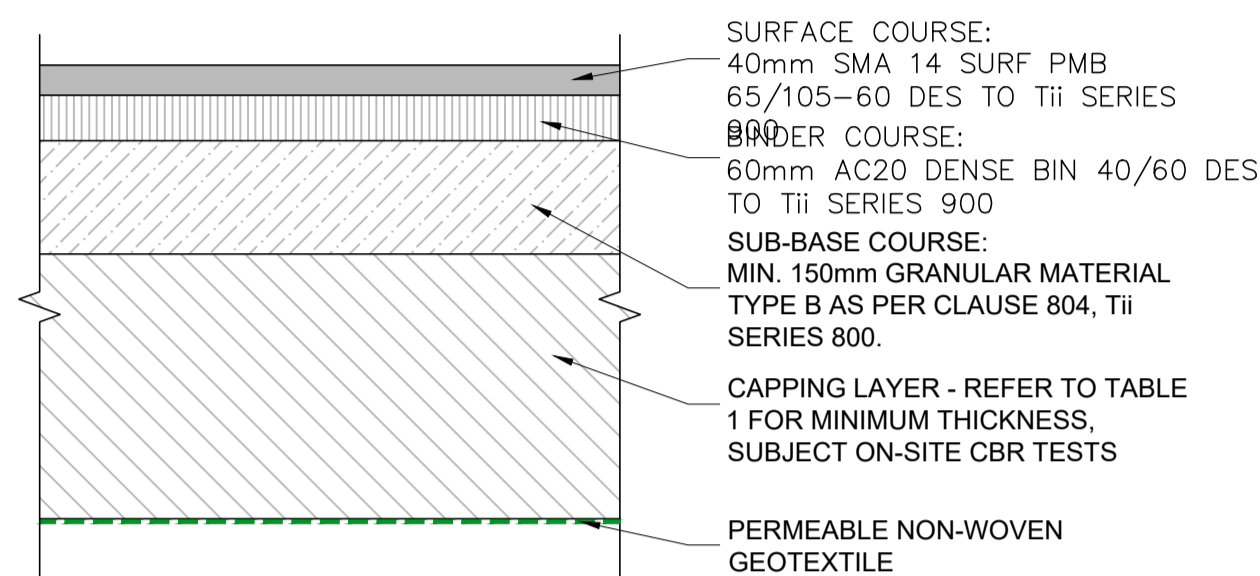

INTERNAL ROAD BUILD-UP DETAIL  
Scale: 1/10 @ A1, 1/20 @ A3

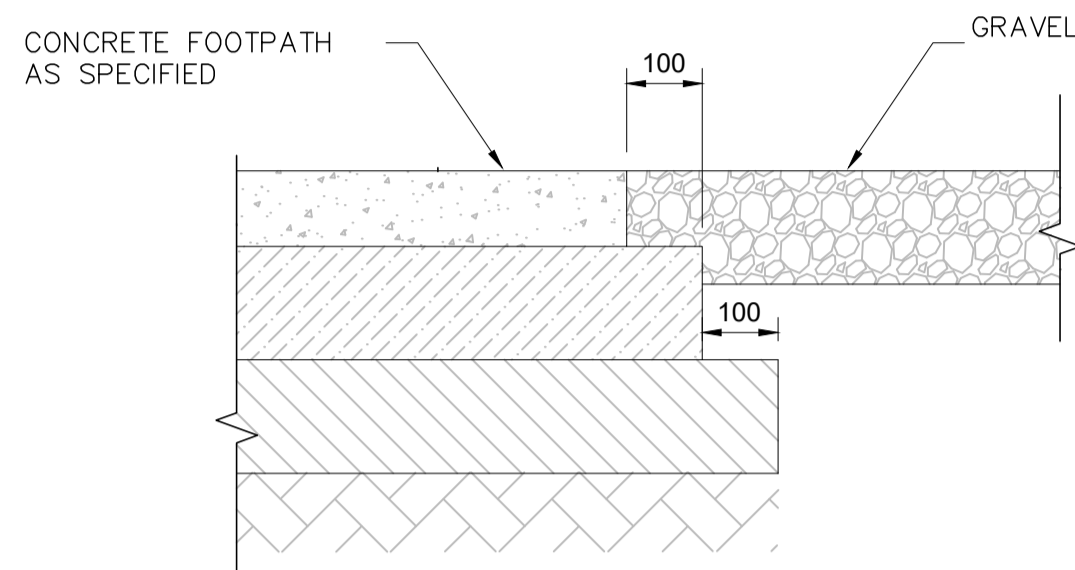

EDGE DETAIL (FOOTPATH TO GRAVEL)  
Scale: 1/10 @ A1, 1/20 @ A3

**NOTES:**  
1. JOINTS TO KERBS WILL BE PROVIDED IN ACCORDANCE WITH THE TII STANDARD 1100. VERTICAL EXPANSION JOINTS AT 40m SPACINGS AND INTERMEDIATE CONTRACTION JOINTS AT 5m SPACINGS SHALL BE FORMED IN KERBS, CHANNELS AND EDGE DETAILS.

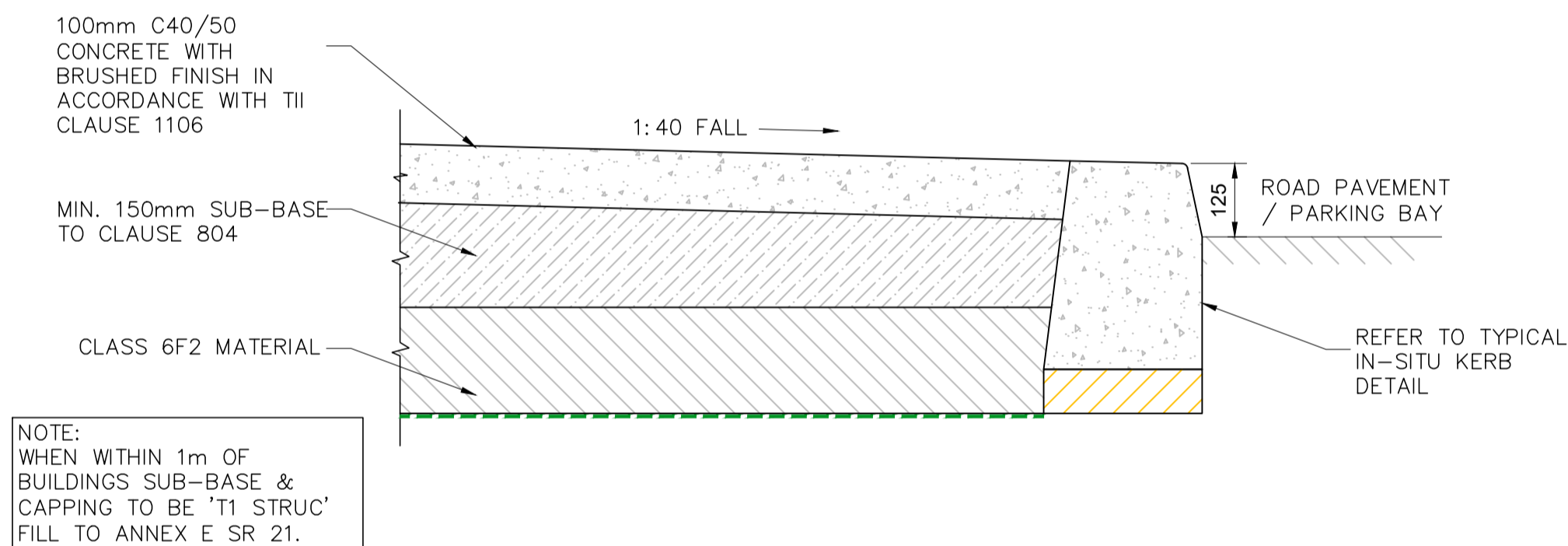

CONCRETE FOOTPATH (NON VEHICULAR)  
Scale: 1/10 @ A1, 1/20 @ A3

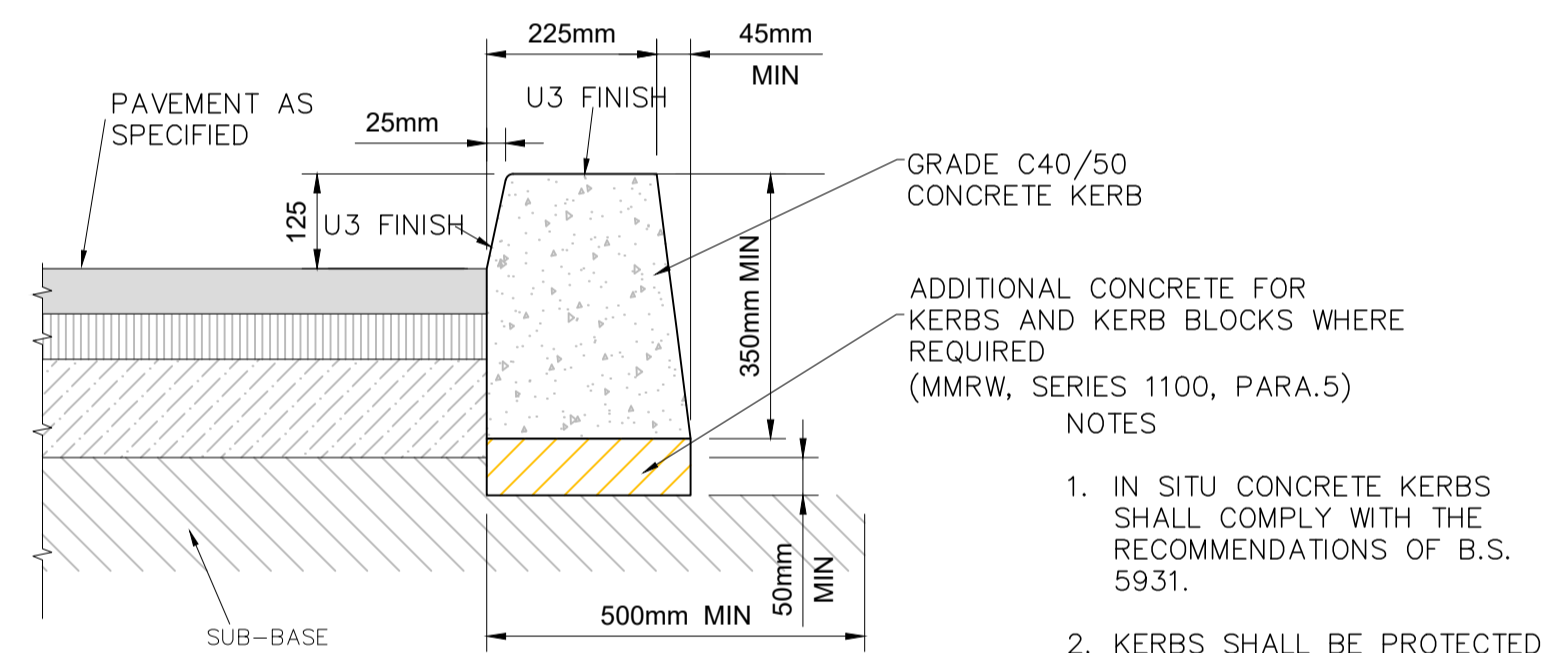

STANDARD IN-SITU CONCRETE KERB  
Scale: 1/10 @ A1, 1/20 @ A3

- NOTES**
1. IN SITU CONCRETE KERBS SHALL COMPLY WITH THE RECOMMENDATIONS OF B.S. 5931.
  2. KERBS SHALL BE PROTECTED FROM THE EFFECTS OF ADVERSE WEATHER UNTIL CURED.

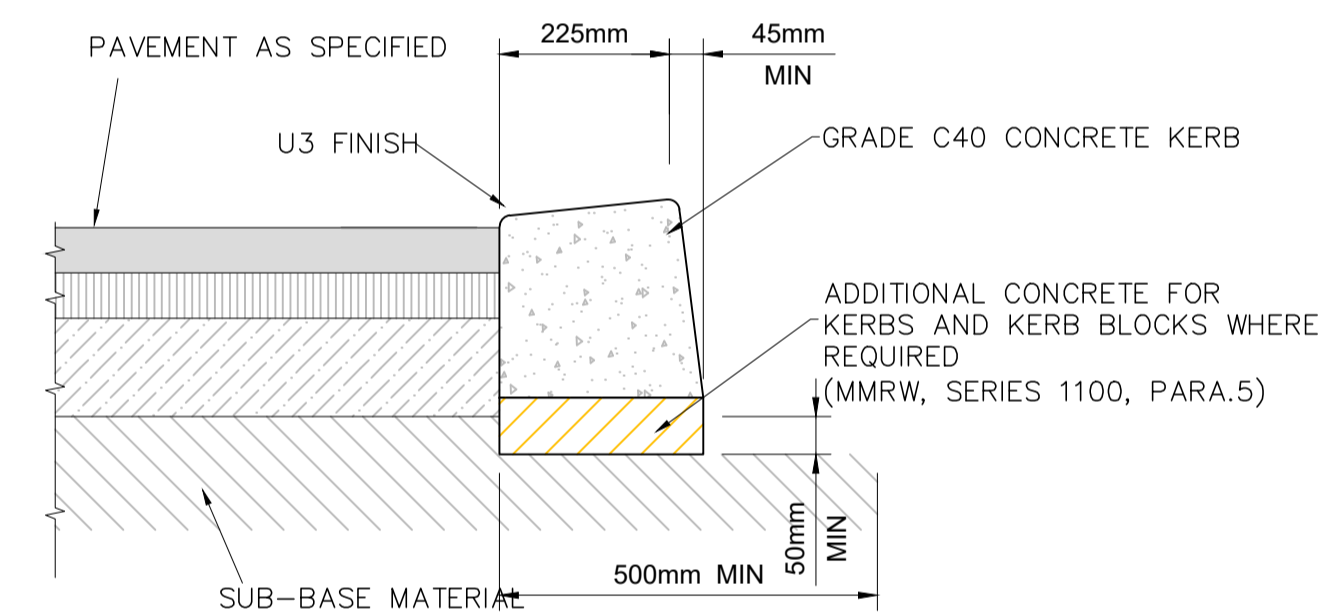

IN-SITU CONCRETE DROP KERB  
Scale: 1/10 @ A1, 1/20 @ A3

Client



General Notes  
(i) Hard copies, dwf and pdf will form a controlled issue of the drawing. All other formats (dwg etc.) are deemed an uncontrolled issue and any work carried out based on these files is at the recipients own risk. RPS will not accept any responsibility for any errors from the use of these files, either by human error by the recipient, listing of the un-dimensioned measurements, compatibility with the recipients software, and any errors arising when these files are used to aid the recipients drawing production, or setting out on site.  
(ii) DO NOT SCALE, use figured dimensions only.

(iii) This drawing is the property of RPS, it is a project confidential classified document. It must not be copied used or its contents divulged without prior written consent. The needs and expectations of client and RPS must be considered when working with this drawing.

(iv) Information including topographical survey, geotechnical investigation and utility detail used in the design have been provided by others.

(v) All Levels refer to Ordnance Survey Datum, Malin Head.

Rev	Date	Drawn By	Amendment / Issue	App
S5 P01	01.08.25	ACB	PLANNING ISSUE	

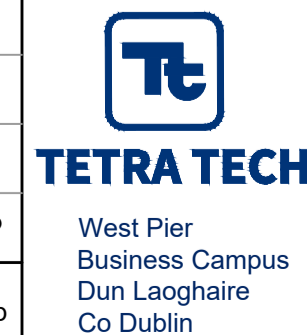

T +353 1 4882900  
F +353 1 2835676  
W www.rpsgroup.com/ireland  
E ireland@rpsgroup.com

Scale A/S @ A1	Project CENTRAL DUBLIN SUBSTATION PROJECT
Created on 21/05/2025	Title PROPOSED TYPICAL ROADWAY DETAILS
Sheets 1 of 1	Drawing Number CP1273-RPS-03-PL-SL-D-C-2108
Status S5	Rev P01